



## FROM \$514,100



**2,453**

Sq.Ft.



**3**

Bedrooms



**2.5**

Bathrooms



**2**

Garage

The Barton Springs GR floor plan features 3 bedrooms, 2.5 bathrooms, a flexible study, and a 2-car side-load garage, offering versatility for various lifestyles. The master suite serves as a private retreat, complete with two walk-in closets, dual sinks, and an oversized walk-in shower. The open-concept family room, dining area, and kitchen provide a welcoming space for both daily living and entertaining.

With its smart design and adaptable layout, the Barton Springs GR caters to your needs.

Like all homes in the Grand Ranch Collection, the starting price includes essential site preparation services, ensuring transparency and simplifying the planning process. These services eliminate surprises and provide clarity from the start. [View the full list of included property services.](#)

**CONTACT US** None

**WWW.TILSONHOMES.COM**



# BARTON SPRINGS

Montgomery County - Republic Grand Ranch, TX

**TILSON**  
CUSTOM HOME BUILDERS



Elevation D | The Barton Springs  
GR



Elevation C | The Barton Springs  
GR

**CONTACT US** None

**WWW.TILSONHOMES.COM**



*Tilson continuously improves home designs and reserves the right to modify home features and specifications without notice or obligation. Square footage is approximate and includes overall dimensions. Renderings are drawn to be substantially correct. Tilson standard features may vary by home design and/or location. Contact a Tilson Sales Associate for details.  
Current information as June 1, 2026, 3:11 p.m.*

## Floor Plan | The Barton Springs GR - Elevation D

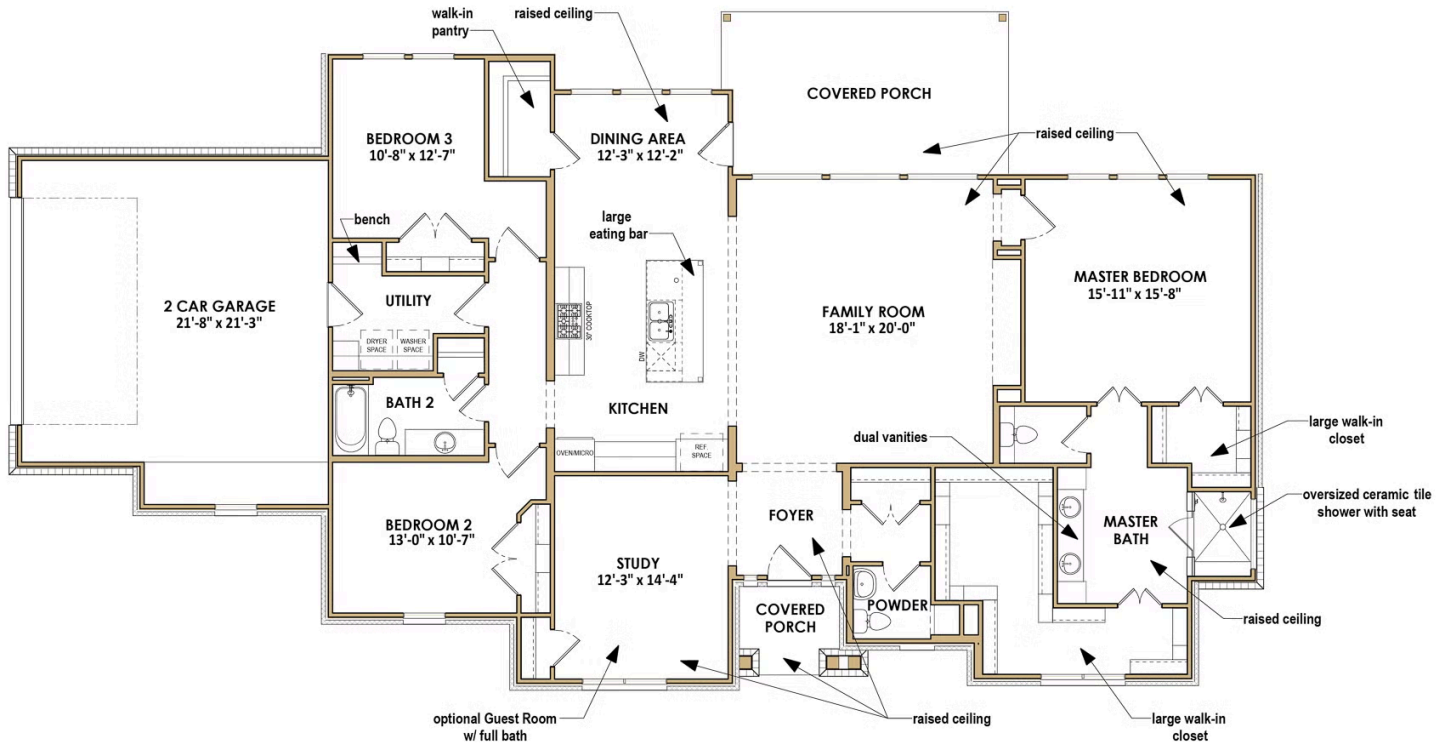

CONTACT US None

[WWW.TILSONHOMES.COM](http://WWW.TILSONHOMES.COM)



Tilson continuously improves home designs and reserves the right to modify home features and specifications without notice or obligation. Square footage is approximate and includes overall dimensions. Renderings are drawn to be substantially correct. Tilson standard features may vary by home design and/or location. Contact a Tilson Sales Associate for details.  
Current information as June 1, 2026, 3:11 p.m.