



FROM \$330,100



1,835

Sq.Ft.



3

Bedrooms



2.0

Bathrooms



1.0

Story

The San Gabriel is a uniquely designed home that is perfect for small families. It has plenty of space for relaxing and entertaining, with a large family room that is open to the dining area and overlooked by an open counter and eating bar in the kitchen. With a raised ceiling and windows throughout, the main gathering space in this home is filled with light. Extending from the right side of the family room is a utility room and the master suite, complete with an oversize ceramic tile shower, soaking tub, large walk-in closet, and dual vanities. Two bedrooms and a full bathroom branch off from the foyer at the front entrance.

CONTACT US None

WWW.TILSONHOMES.COM



Tilson continuously improves home designs and reserves the right to modify home features and specifications without notice or obligation. Square footage is approximate and includes overall dimensions. Renderings are drawn to be substantially correct. Tilson standard features may vary by home design and/or location. Contact a Tilson Sales Associate for details. Current information as June 10, 2026, 1:56 p.m.



Elevation D - The San Gabriel

CONTACT US None

WWW.TILSONHOMES.COM



*Tilson continuously improves home designs and reserves the right to modify home features and specifications without notice or obligation. Square footage is approximate and includes overall dimensions. Renderings are drawn to be substantially correct. Tilson standard features may vary by home design and/or location. Contact a Tilson Sales Associate for details.
Current information as June 10, 2026, 1:56 p.m.*

Floorplan - The San Gabriel D

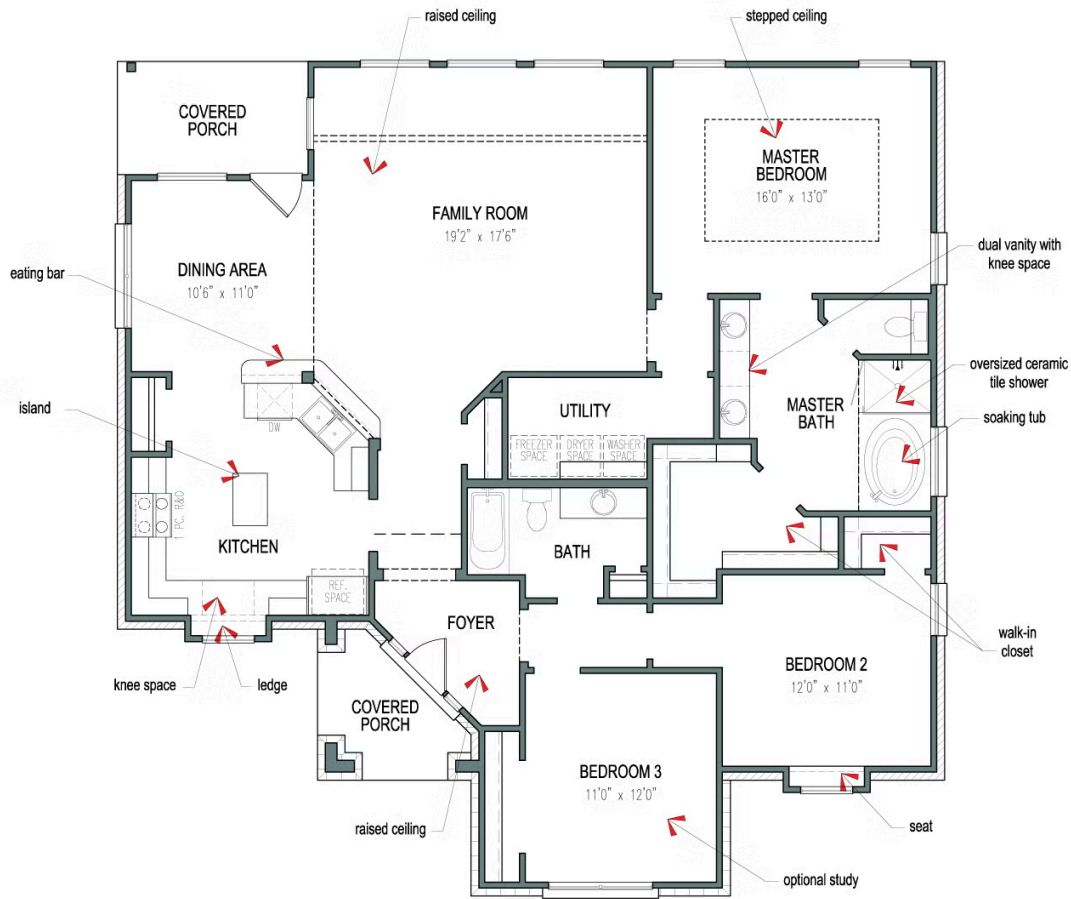

CONTACT US None

WWW.TILSONHOMES.COM

