



FROM \$408,200



2,259

Sq.Ft.



3

Bedrooms



2.5

Bathrooms



1.0

Story



0

Garage

Light fills the wide-open spaces of the Magnolia. The front entrance opens into a spacious foyer with a study and closet to the left. The large family room ahead flows into the kitchen and dining area, with an adjacent open flex room that is perfect to use as an entertainment room, separate lounge, or anything you desire. A hallway extends from the flex room, leading to two bedrooms, a full bathroom, and the utility room. The master suite is situated at the other side of the layout, and includes two walk-in closets, a powder room, large seated shower, and a soaking tub.

CONTACT US

WWW.TILSONHOMES.COM



Tilson continuously improves home designs and reserves the right to modify home features and specifications without notice or obligation. Square footage is approximate and includes overall dimensions. Renderings are drawn to be substantially correct. Tilson standard features may vary by home design and/or location. Contact a Tilson Sales Associate for details. Current information as Jan. 4, 2024, 5:17 p.m.

MAGNOLIA

Palo Pinto County, TX

TILSON
CUSTOM HOME BUILDERS



CONTACT US

WWW.TILSONHOMES.COM



*Tilson continuously improves home designs and reserves the right to modify home features and specifications without notice or obligation. Square footage is approximate and includes overall dimensions. Renderings are drawn to be substantially correct. Tilson standard features may vary by home design and/or location. Contact a Tilson Sales Associate for details.
Current information as Jan. 4, 2024, 5:17 p.m.*

Floorplan - The Magnolia

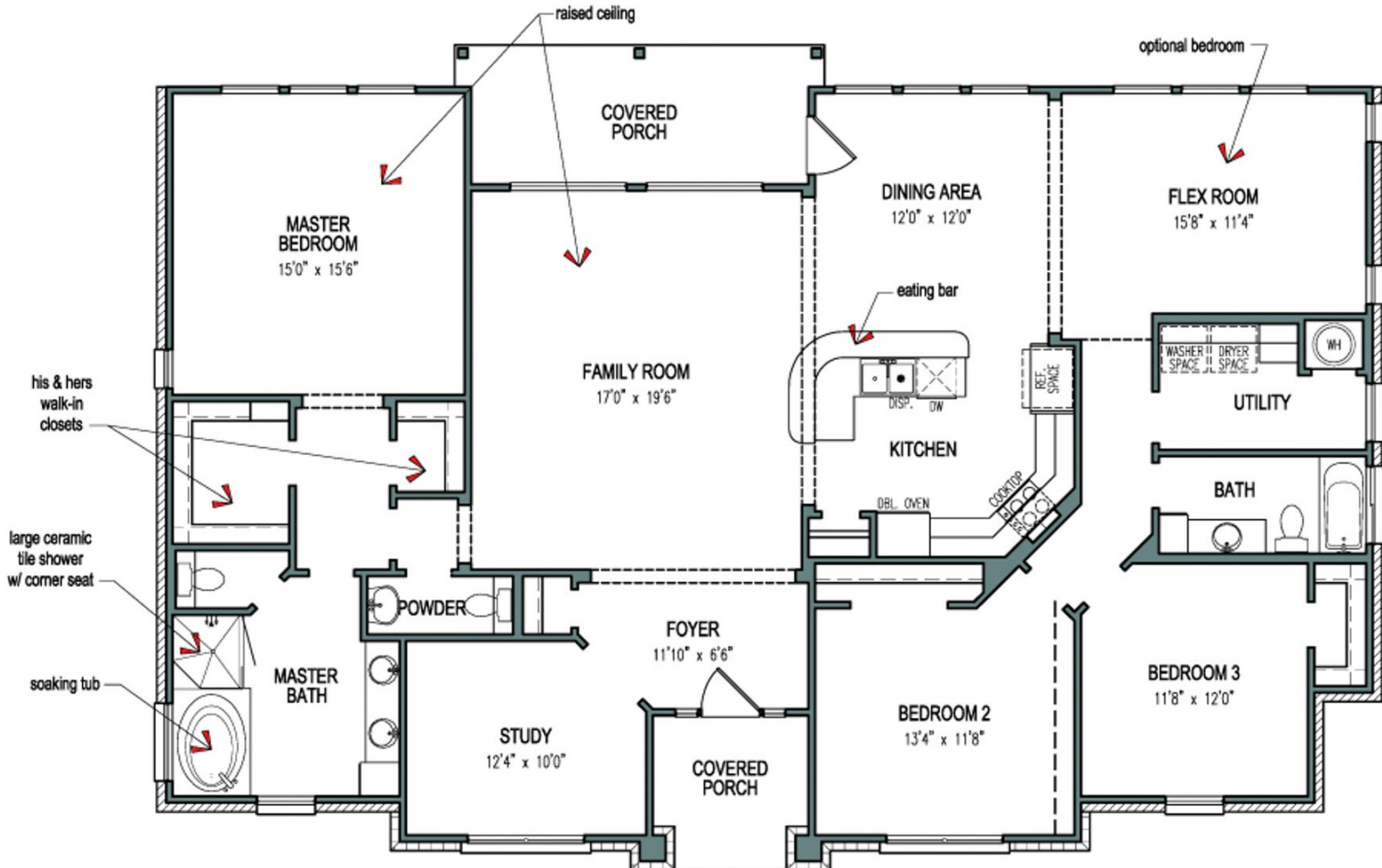

CONTACT US

WWW.TILSONHOMES.COM



Tilson continuously improves home designs and reserves the right to modify home features and specifications without notice or obligation. Square footage is approximate and includes overall dimensions. Renderings are drawn to be substantially correct. Tilson standard features may vary by home design and/or location. Contact a Tilson Sales Associate for details. Current information as Jan. 4, 2024, 5:17 p.m.