



## FROM \$545,800



**2,551**

Sq.Ft.



**3**

Bedrooms



**2.5**

Bathrooms



**1.0**

Story



**2**

Garage

The Palo Duro GR, part of Tilson's Deer Forest collection, blends smart design with Texas acreage charm. Its open-concept family room, kitchen, and dining area feature raised ceilings and wood beams for a welcoming touch. The kitchen includes a large eating bar and walk-in pantry. The private master suite offers a dual vanity, oversized tile shower, and walk-in closet, while two additional bedrooms with walk-in closets share a nearby bath. A study near the foyer adds flexibility, and the home includes a drop zone, utility room, covered porches, and a two-car garage, making it practical and timeless.

As with all homes in the Deer Forest Collection, the starting price includes essential site preparation services, ensuring a transparent and straightforward planning process. These services eliminate surprises and provide clarity from the beginning. [View the full list of included property services.](#)

**CONTACT US** None

**WWW.TILSONHOMES.COM**



*Tilson continuously improves home designs and reserves the right to modify home features and specifications without notice or obligation. Square footage is approximate and includes overall dimensions. Renderings are drawn to be substantially correct. Tilson standard features may vary by home design and/or location. Contact a Tilson Sales Associate for details. Current information as June 5, 2026, 6:33 p.m.*

# PALO DURO

Walker County - Deer Forest, TX

**TILSON**  
CUSTOM HOME BUILDERS



Elevation C | The Palo Duro GR



Elevation D | The Palo Duro GR

**CONTACT US** None

**WWW.TILSONHOMES.COM**



*Tilson continuously improves home designs and reserves the right to modify home features and specifications without notice or obligation. Square footage is approximate and includes overall dimensions. Renderings are drawn to be substantially correct. Tilson standard features may vary by home design and/or location. Contact a Tilson Sales Associate for details.  
Current information as June 5, 2026, 6:33 p.m.*

## Floor Plan | The Palo Duro GR - Elevation D

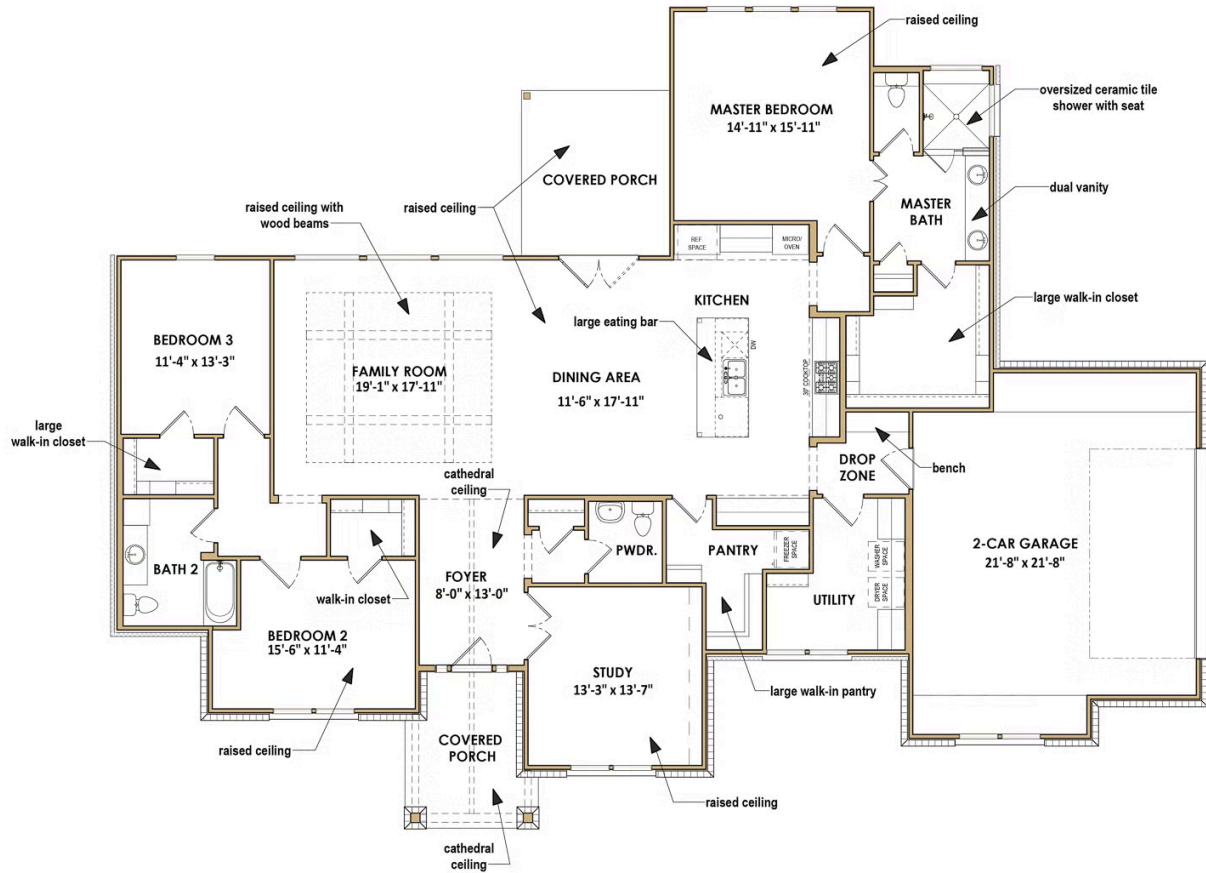

CONTACT US None

[WWW.TILSONHOMES.COM](http://WWW.TILSONHOMES.COM)



Tilson continuously improves home designs and reserves the right to modify home features and specifications without notice or obligation. Square footage is approximate and includes overall dimensions. Renderings are drawn to be substantially correct. Tilson standard features may vary by home design and/or location. Contact a Tilson Sales Associate for details. Current information as June 5, 2026, 6:33 p.m.