



FROM \$623,500



2,831

Sq.Ft.



3

Bedrooms



2.5

Bathrooms



1.0

Story



2

Garage

The Rockwall is a spacious home that is perfect for growing and active families. At the center is a large family room that is open to the adjacent kitchen and breakfast nook. The kitchen features a long central island with an eating bar and a walk-in pantry, and the entire space is filled with light from a wall of windows. The secluded luxurious master suite notably features a sloped ceiling with wooden beams in the bedroom, as well as a vast walk-in closet and soaking tub. Two bedrooms and a versatile study are on the opposite side of the home. An attached 2-car garage and storage garage lead into the utility room and drop zone, providing easy alternate entry points.

CONTACT US None

WWW.TILSONHOMES.COM





Elevation B - The Rockwall



Elevation C - The Rockwall

CONTACT US None

WWW.TILSONHOMES.COM



*Tilson continuously improves home designs and reserves the right to modify home features and specifications without notice or obligation. Square footage is approximate and includes overall dimensions. Renderings are drawn to be substantially correct. Tilson standard features may vary by home design and/or location. Contact a Tilson Sales Associate for details.
Current information as Jan. 5, 2026, 9:52 a.m.*

Floorplan - The Rockwall

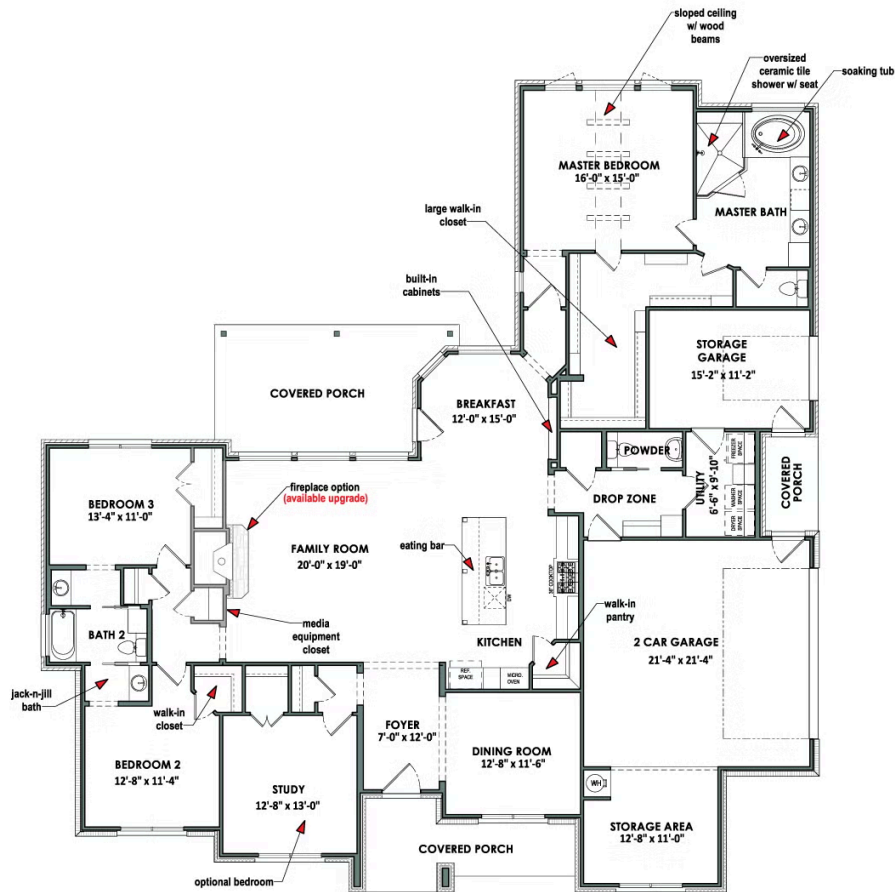

CONTACT US None

WWW.TILSONHOMES.COM



Tilson continuously improves home designs and reserves the right to modify home features and specifications without notice or obligation. Square footage is approximate and includes overall dimensions. Renderings are drawn to be substantially correct. Tilson standard features may vary by home design and/or location. Contact a Tilson Sales Associate for details. Current information as Jan. 5, 2026, 9:52 a.m.