



**FROM \$276,200**



**1,547**

Sq.Ft.



**3**

Bedrooms



**2.0**

Bathrooms



**1.0**

Story

The Floresville is an efficiently designed home with wide-open spaces and separate living quarters. Entering from a covered porch, a modest foyer leads directly into the kitchen, which features an island with a large eating bar and a walk-in pantry. The kitchen flows into the dining area and family room, highlighted by a wall of windows and a rear exterior door that lets in plenty of natural light. Adjacent to the dining area is the master suite, which boasts a spacious walk-in closet. Back at the foyer, two bedrooms with sizable closets and a full bathroom branch off to the right, while a utility room and a small closet are positioned to the left.

**CONTACT US** None

**WWW.TILSONHOMES.COM**



*Tilson continuously improves home designs and reserves the right to modify home features and specifications without notice or obligation. Square footage is approximate and includes overall dimensions. Renderings are drawn to be substantially correct. Tilson standard features may vary by home design and/or location. Contact a Tilson Sales Associate for details.  
Current information as July 9, 2025, 4:17 p.m.*



Elevation D - The Floresville



Elevation A - The Floresville



Elevation B - The Floresville



Elevation C - The Floresville

**CONTACT US** None

**WWW.TILSONHOMES.COM**



*Tilson continuously improves home designs and reserves the right to modify home features and specifications without notice or obligation. Square footage is approximate and includes overall dimensions. Renderings are drawn to be substantially correct. Tilson standard features may vary by home design and/or location. Contact a Tilson Sales Associate for details.  
Current information as July 9, 2025, 4:17 p.m.*

## Floorplan - The Floresville

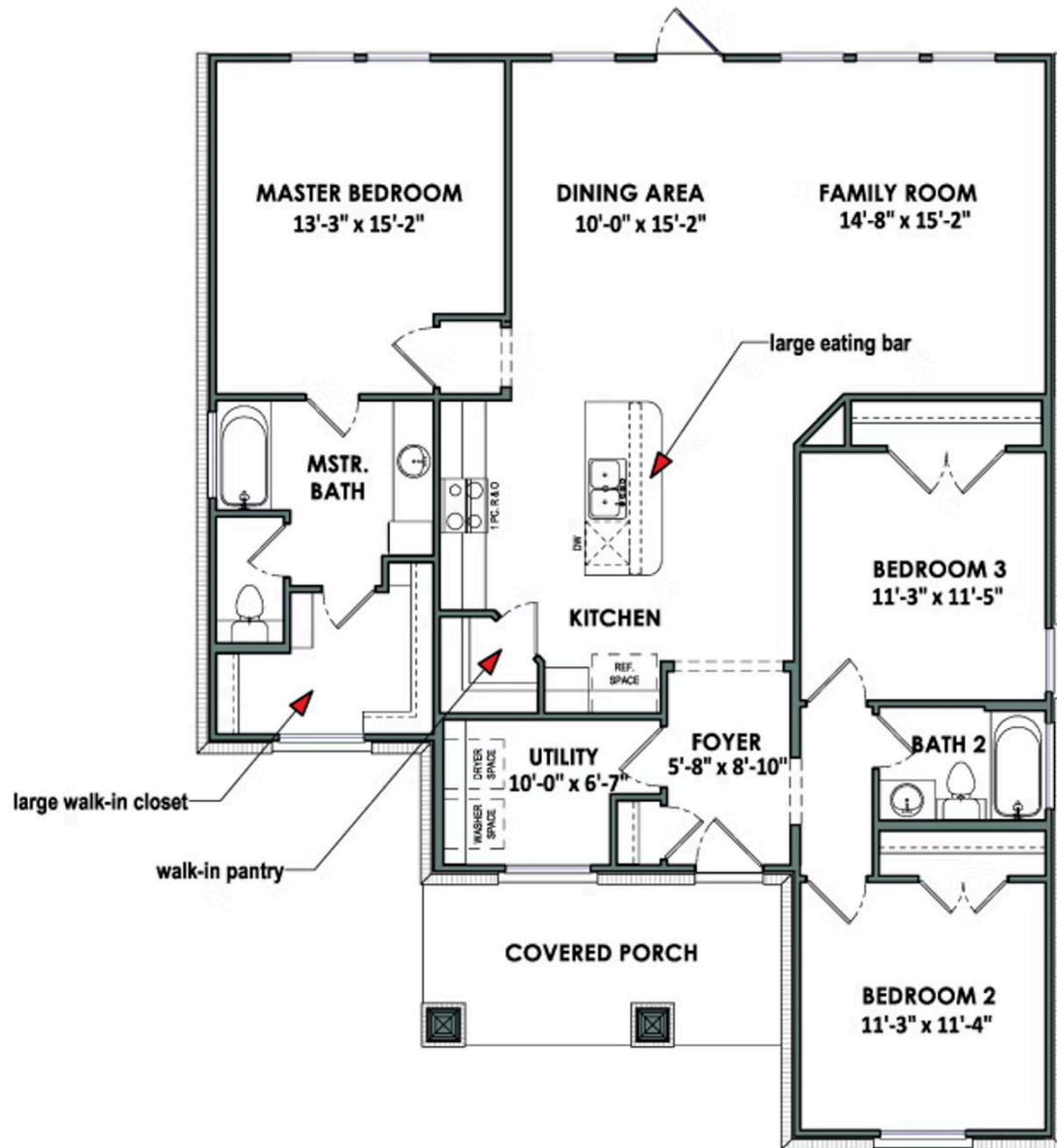

**CONTACT US** None

**WWW.TILSONHOMES.COM**



*Tilson continuously improves home designs and reserves the right to modify home features and specifications without notice or obligation. Square footage is approximate and includes overall dimensions. Renderings are drawn to be substantially correct. Tilson standard features may vary by home design and/or location. Contact a Tilson Sales Associate for details.  
Current information as July 9, 2025, 4:17 p.m.*