



## FROM \$333,000



**1,772**

Sq.Ft.



**3**

Bedrooms



**2.0**

Bathrooms



**1.0**

Story

The Whitney is a spacious home with plenty of large windows throughout to fill it with natural light.

The foyer opens into a family room with a raised ceiling, open to the dining area attached to the kitchen. The kitchen features an eating bar separating it from the family room, a center work island, and a walk-in pantry, with extra freezer space in the adjacent utility room. The master suite on the opposite side at the rear of the home has two large walk-in closets, dual vanities, and a walk-in seated shower. Two bedrooms with walk-in closets and a full bathroom make up the living quarters toward the front. Front and rear porches complete this gorgeous home.

**CONTACT US**

**WWW.TILSONHOMES.COM**



*Tilson continuously improves home designs and reserves the right to modify home features and specifications without notice or obligation. Square footage is approximate and includes overall dimensions. Renderings are drawn to be substantially correct. Tilson standard features may vary by home design and/or location. Contact a Tilson Sales Associate for details. Current information as April 7, 2025, 10:56 a.m.*

# WHITNEY

Gonzales County, TX

**TILSON**  
CUSTOM HOME BUILDERS



Elevation D - The Whitney



Elevation C - The Whitney



Elevation B - The Whitney



Elevation A - The Whitney

**CONTACT US**

**[WWW.TILSONHOMES.COM](http://WWW.TILSONHOMES.COM)**



*Tilson continuously improves home designs and reserves the right to modify home features and specifications without notice or obligation. Square footage is approximate and includes overall dimensions. Renderings are drawn to be substantially correct. Tilson standard features may vary by home design and/or location. Contact a Tilson Sales Associate for details. Current information as April 7, 2025, 10:56 a.m.*

**Floorplan - The Whitney D**

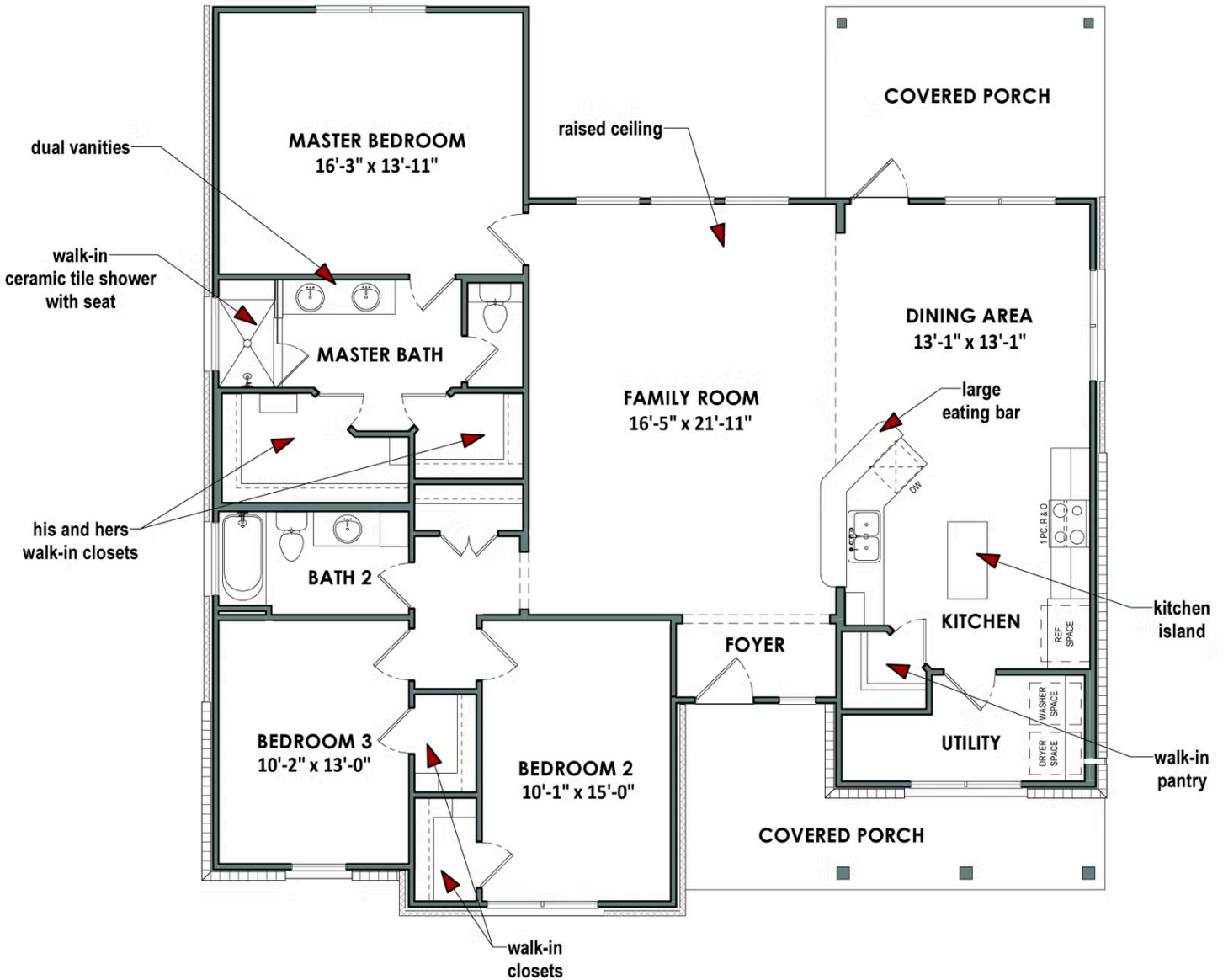

**CONTACT US**

**WWW.TILSONHOMES.COM**

