

LIVE OAK

Somervell County, TX

TILSON
CUSTOM HOME BUILDERS



FROM \$342,800



1,957

Sq.Ft.



3

Bedrooms



2.0

Bathrooms



None

Story



None

Garage

This three bedroom, two bathroom home is designed for both indoor and outdoor living. A large front and back porch provide plenty of space to entertain outside. Large windows on the back of the main living area bring in natural light as you enjoy your property's views. The fully-equipped kitchen features ample counter space plus an eating bar close by a walk-in pantry. The master suite has an oversized ceramic tile shower and large walk-in closet. Two secondary bedrooms and another full bathroom finish out the layout.

CONTACT US

WWW.TILSONHOMES.COM



*Tilson continuously improves home designs and reserves the right to modify home features and specifications without notice or obligation. Square footage is approximate and includes overall dimensions. Renderings are drawn to be substantially correct. Tilson standard features may vary by home design and/or location. Contact a Tilson Sales Associate for details.
Current information as June 7, 2023, 9:49 a.m.*

Floor Plan for Elevation C | The Live Oak

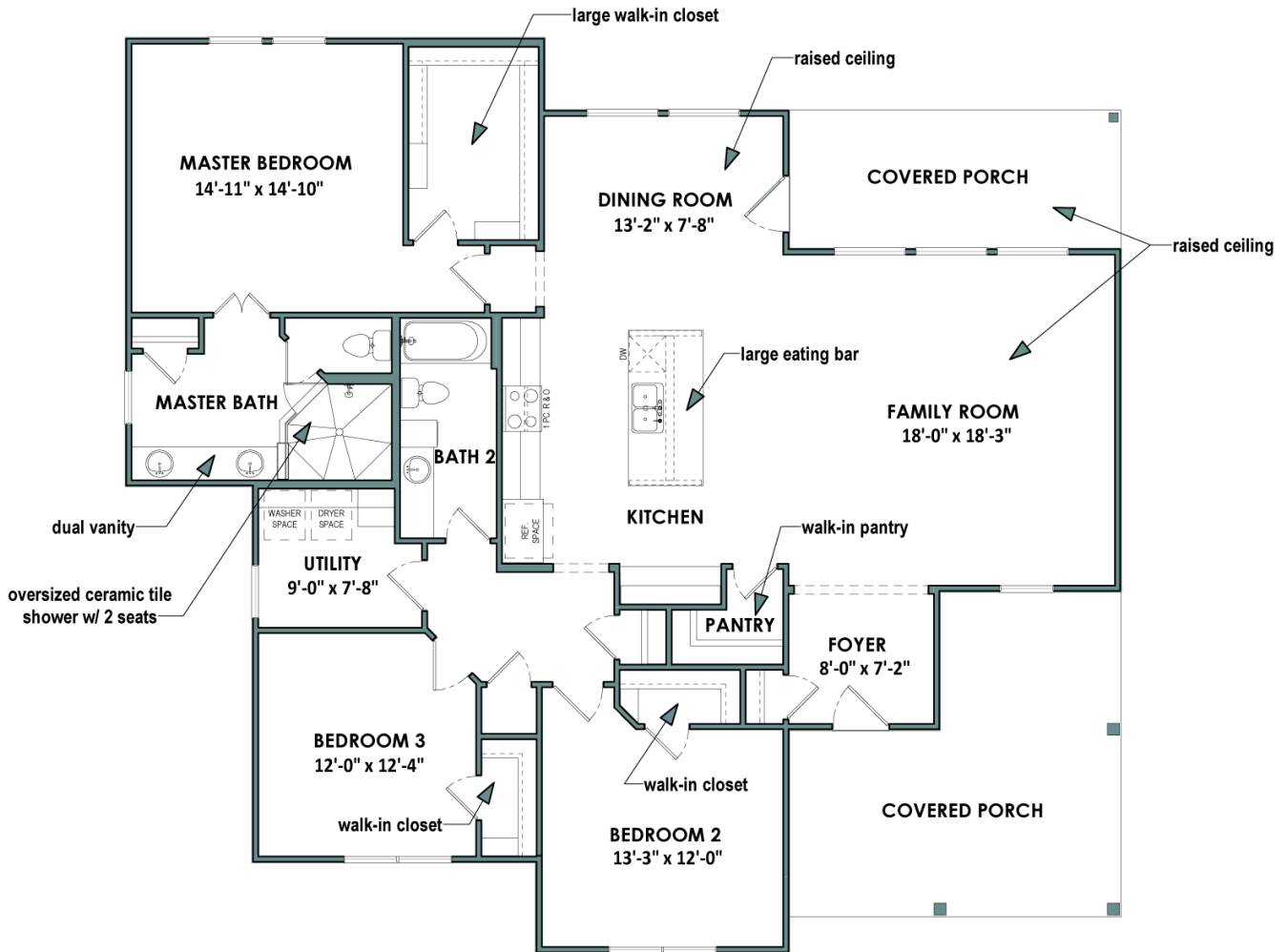

CONTACT US

WWW.TILSONHOMES.COM

