

FLORESVILLE

Delta County, TX

TILSON
CUSTOM HOME BUILDERS



FROM \$280,900



1,610

Sq.Ft.



3

Bedrooms



2.0

Bathrooms



1.0

Story



0

Garage

The Floresville is an efficiently designed home with wide open spaces and separated living quarters. Coming in from a covered porch, a modest foyer leads straight into the kitchen, which features an island with a large eating bar and walk-in pantry. The kitchen flows into the dining area and family room with a wall of windows and rear exterior door to let in plenty of light. Adjacent to the dining area is the master suite, which features a large walk-in closet. Back to the foyer, two bedrooms with sizable closets and a full bathroom branch off on the right side, and a utility room and small closet are situated on the left.

CONTACT US

WWW.TILSONHOMES.COM



Tilson continuously improves home designs and reserves the right to modify home features and specifications without notice or obligation. Square footage is approximate and includes overall dimensions. Renderings are drawn to be substantially correct. Tilson standard features may vary by home design and/or location. Contact a Tilson Sales Associate for details. Current information as June 7, 2023, 9:14 a.m.

FLORESVILLE

Delta County, TX

TILSON
CUSTOM HOME BUILDERS



Elevation D - The Floresville



Elevation A - The Floresville



Elevation B - The Floresville



Elevation C - The Floresville

CONTACT US

WWW.TILSONHOMES.COM



Tilson continuously improves home designs and reserves the right to modify home features and specifications without notice or obligation. Square footage is approximate and includes overall dimensions. Renderings are drawn to be substantially correct. Tilson standard features may vary by home design and/or location. Contact a Tilson Sales Associate for details. Current information as June 7, 2023, 9:14 a.m.

Floorplan - The Floresville

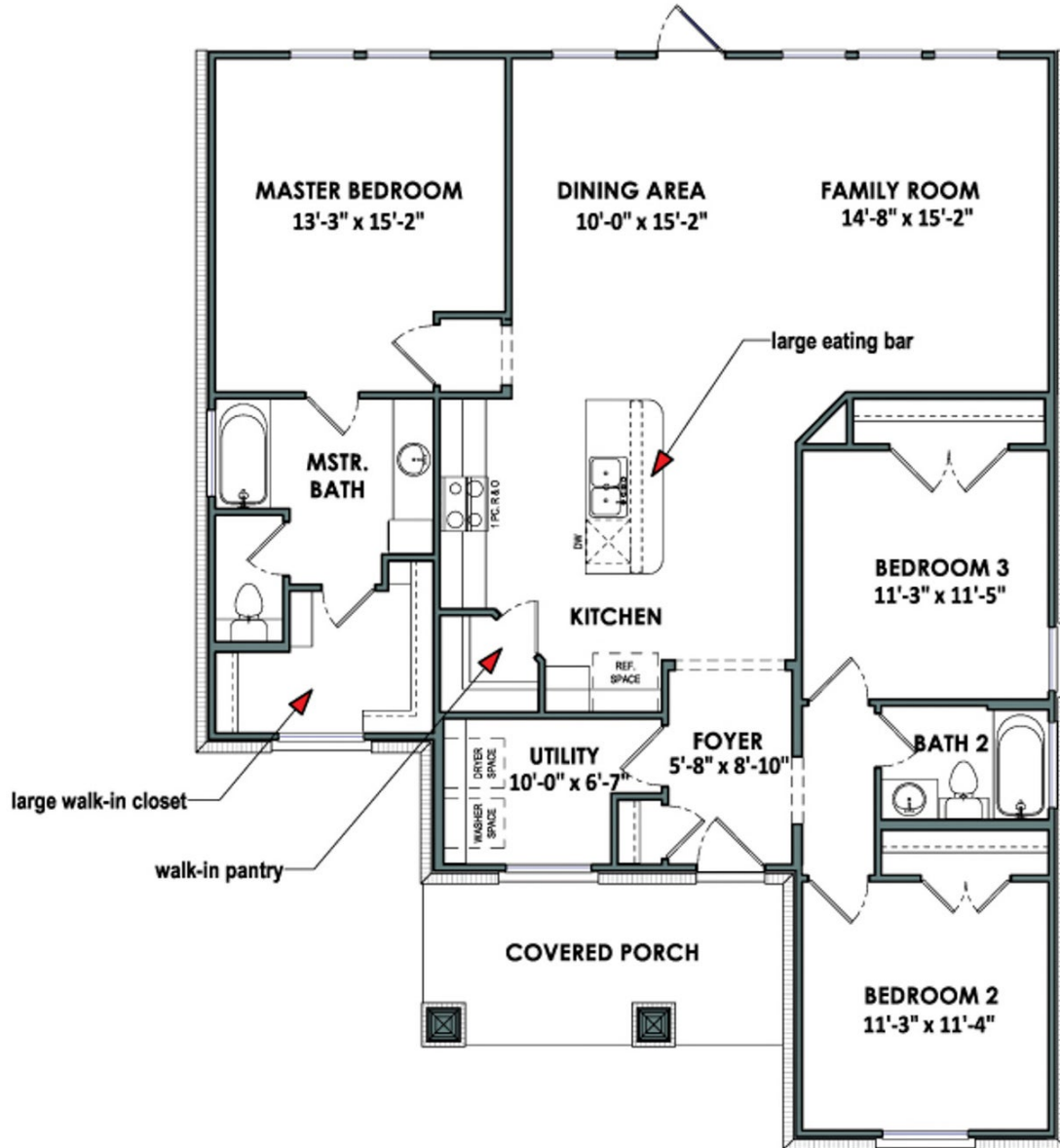

CONTACT US

WWW.TILSONHOMES.COM

