



FROM \$454,700



2,551

Sq.Ft.



3

Bedrooms



2.5

Bathrooms



1.0

Story

The Palo Duro offers a thoughtfully designed split floor plan, highlighted by a spacious master suite that's perfect for escaping the hustle and bustle of everyday life. Its open layout makes it ideal for hosting guests or relaxing on one of the two covered porches. Additional features include a dedicated study, a generously sized walk-in pantry, and a roomy kitchen, all of which add to the flexibility and customization options of this versatile home plan.

CONTACT US None

WWW.TILSONHOMES.COM



Tilson continuously improves home designs and reserves the right to modify home features and specifications without notice or obligation. Square footage is approximate and includes overall dimensions. Renderings are drawn to be substantially correct. Tilson standard features may vary by home design and/or location. Contact a Tilson Sales Associate for details. Current information as Jan. 5, 2026, 10 a.m.



Elevation A | The Palo Duro



Elevation B | The Palo Duro



Elevation C | The Palo Duro



Elevation D | The Palo Duro



Elevation E | The Palo Duro

CONTACT US None

WWW.TILSONHOMES.COM



Tilson continuously improves home designs and reserves the right to modify home features and specifications without notice or obligation. Square footage is approximate and includes overall dimensions. Renderings are drawn to be substantially correct. Tilson standard features may vary by home design and/or location. Contact a Tilson Sales Associate for details. Current information as Jan. 5, 2026, 10 a.m.

Floorplan | Elevation E | The Palo Duro

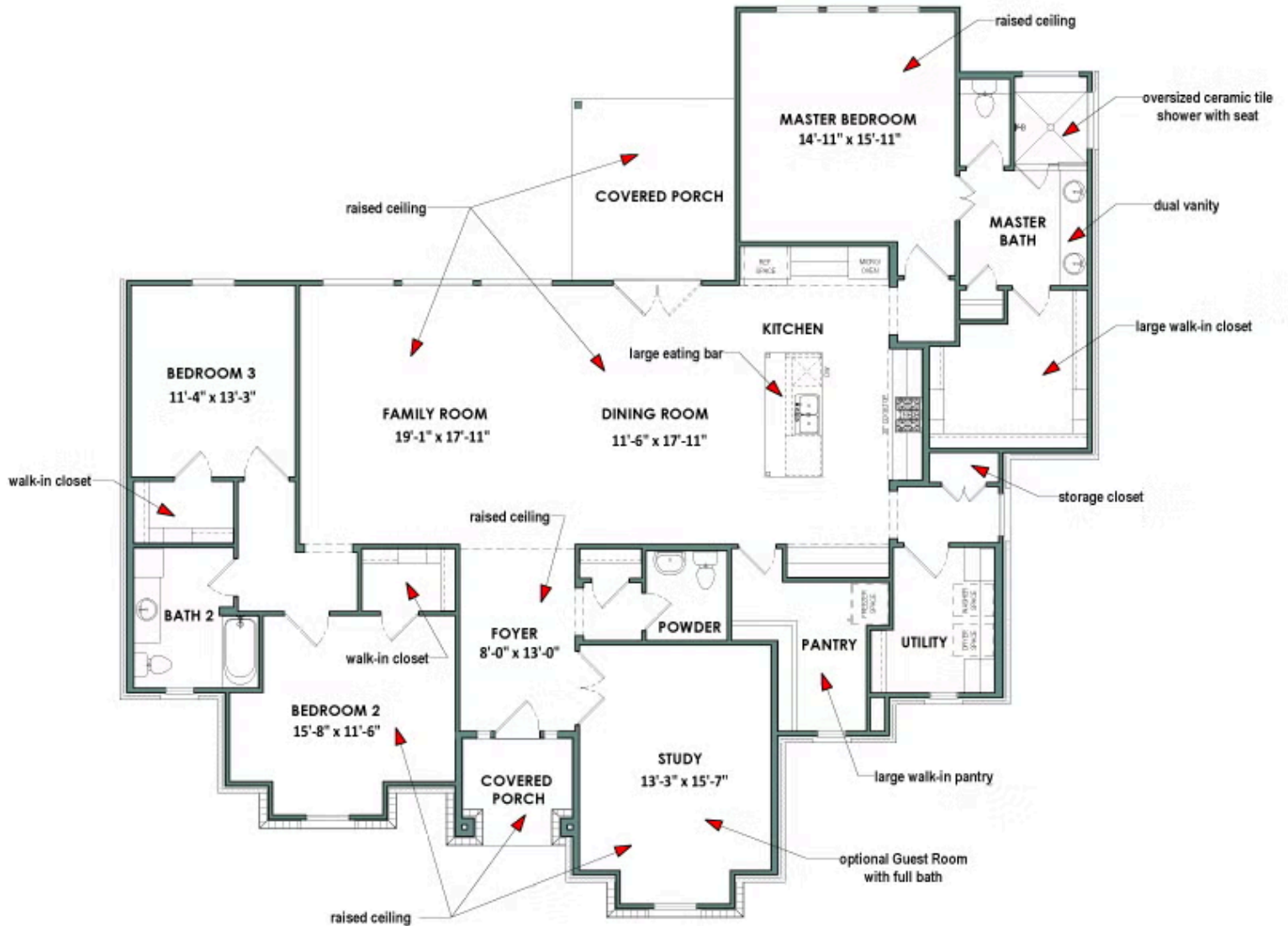

CONTACT US None

WWW.TILSONHOMES.COM



*Tilson continuously improves home designs and reserves the right to modify home features and specifications without notice or obligation. Square footage is approximate and includes overall dimensions. Renderings are drawn to be substantially correct. Tilson standard features may vary by home design and/or location. Contact a Tilson Sales Associate for details.
Current information as Jan. 5, 2026, 10 a.m.*