



FROM \$356,300



1,957

Sq.Ft.



3

Bedrooms



2.0

Bathrooms

This three bedroom, two bathroom home is designed for both indoor and outdoor living. A large front and back porch provide plenty of space to entertain outside. Large windows at the rear of the main living area fill the space with natural light and showcase your property's views. The fully-equipped kitchen offers generous counter space, an eating bar, and a nearby walk-in pantry. The master suite has an oversized ceramic tile shower and a large walk-in closet. Two secondary bedrooms and an additional full bathroom complete the layout.

CONTACT US None

WWW.TILSONHOMES.COM



*Tilson continuously improves home designs and reserves the right to modify home features and specifications without notice or obligation. Square footage is approximate and includes overall dimensions. Renderings are drawn to be substantially correct. Tilson standard features may vary by home design and/or location. Contact a Tilson Sales Associate for details.
Current information as Jan. 5, 2026, 9:22 a.m.*

Floor Plan for Elevation C | The Live Oak

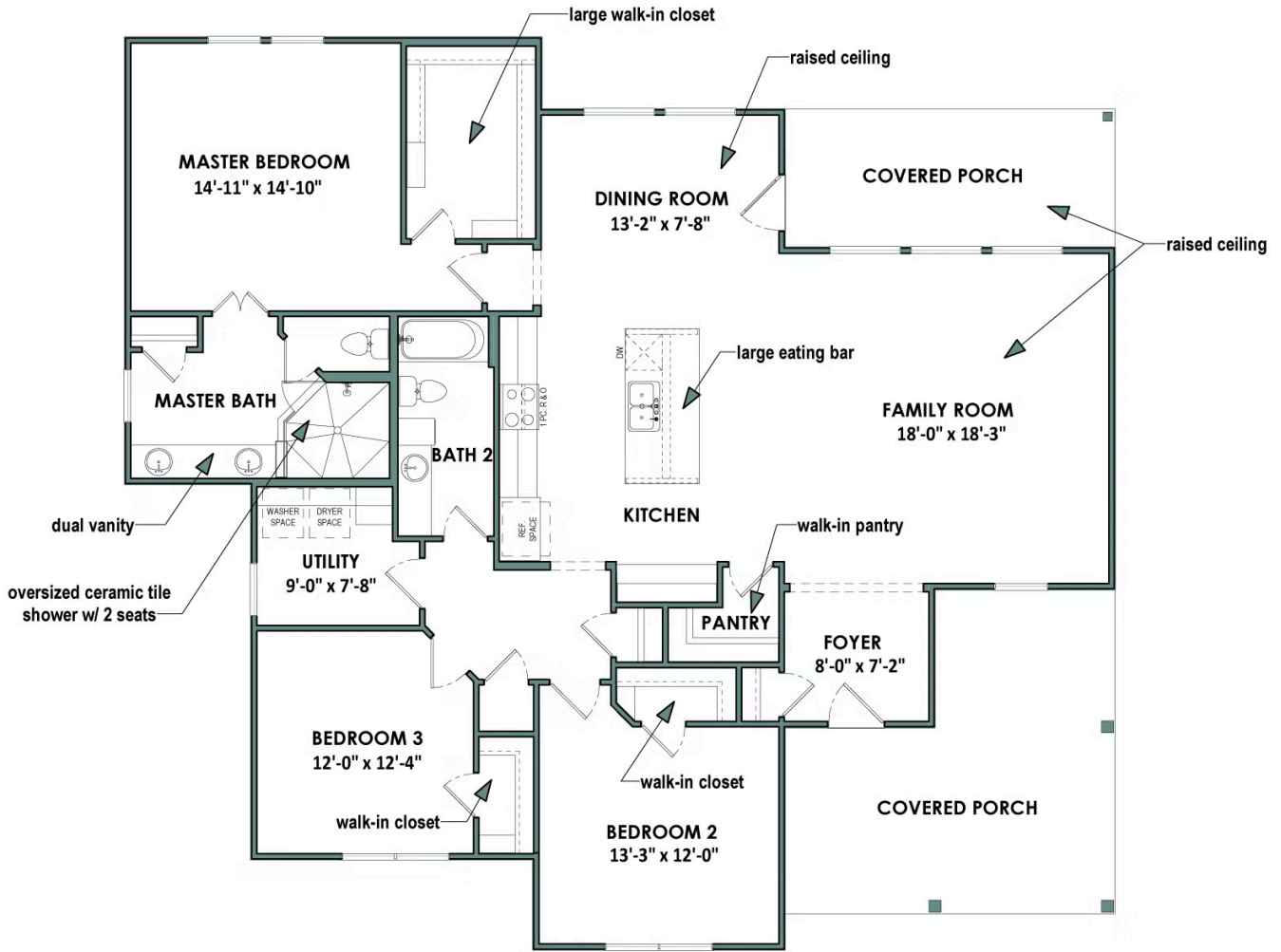

CONTACT US None

WWW.TILSONHOMES.COM

