



## FROM \$387,400



**2,356**

Sq.Ft.



**3**

Bedrooms



**2.5**

Bathrooms



**1.0**

Story



**None**

Garage

The Abilene is perfect for the family that values space. The entrance of the home leads into a large family room with a raised ceiling and multiple windows that fill it with light. Adjacent is an open dining room that flows into the sizable kitchen with an eating bar and plenty of storage space. Private living quarters are situated at the left side of the home, with two bedrooms, a full bathroom, and a utility room. The master suite on the other side notably features a bathroom with dual vanities and walk-in closets. Convert the study at the front entrance into another bedroom for more space, or build a secluded home office.

**CONTACT US**

**WWW.TILSONHOMES.COM**



# ABILENE

Kendall County, TX

**TILSON**  
CUSTOM HOME BUILDERS



Elevation C | The Abilene



Elevation B | The Abilene



Elevation D | The Abilene



Elevation A | The Abilene

CONTACT US

[WWW.TILSONHOMES.COM](http://WWW.TILSONHOMES.COM)



*Tilson continuously improves home designs and reserves the right to modify home features and specifications without notice or obligation. Square footage is approximate and includes overall dimensions. Renderings are drawn to be substantially correct. Tilson standard features may vary by home design and/or location. Contact a Tilson Sales Associate for details. Current information as April 19, 2024, 6:04 p.m.*

## Floor Plan | Elevation D | The Abilene

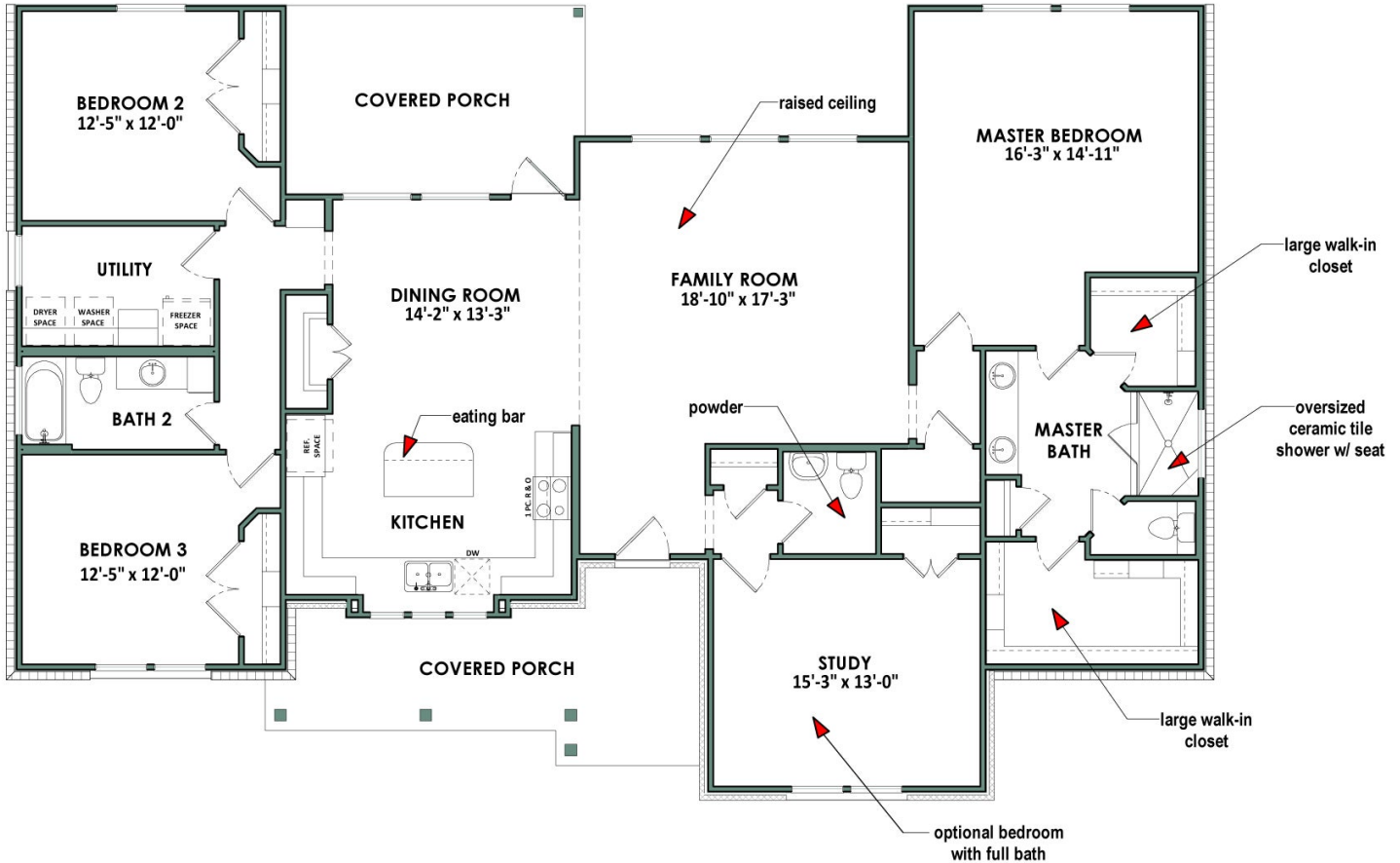

CONTACT US

WWW.TILSONHOMES.COM

