



**2,339**

Sq.Ft.



**3**

Bedrooms



**3.5**

Bathrooms

The Barton Springs floorplan offers 3 bedrooms, 2.5 bathrooms, and a flexible study, making it perfect for a variety of lifestyles. The master suite is a luxurious retreat with two spacious walk-in closets, dual sinks, and an oversized walk-in shower. The open-concept family room, dining area, and kitchen create an inviting space for entertaining and everyday living. With its thoughtful design and versatile layout, the Barton Springs is a home that adapts to your needs.

[WWW.TILSONHOMES.COM](http://WWW.TILSONHOMES.COM)



*Tilson continuously improves home designs and reserves the right to modify home features and specifications without notice or obligation. Square footage is approximate and includes overall dimensions. Renderings are drawn to be substantially correct. Tilson standard features may vary by home design and/or location. Contact a Tilson Sales Associate for details. Current information as July 9, 2025, 12:47 p.m.*



Elevation A | The Barton Springs



Elevation B | The Barton Springs



Elevation C | The Barton Springs



Elevation D | The Barton Springs



Elevation E | The Barton Springs

**CONTACT US**

**[WWW.TILSONHOMES.COM](http://WWW.TILSONHOMES.COM)**



*Tilson continuously improves home designs and reserves the right to modify home features and specifications without notice or obligation. Square footage is approximate and includes overall dimensions. Renderings are drawn to be substantially correct. Tilson standard features may vary by home design and/or location. Contact a Tilson Sales Associate for details. Current information as July 9, 2025, 12:47 p.m.*

## Floor Plan | Elevation D | The Barton Springs

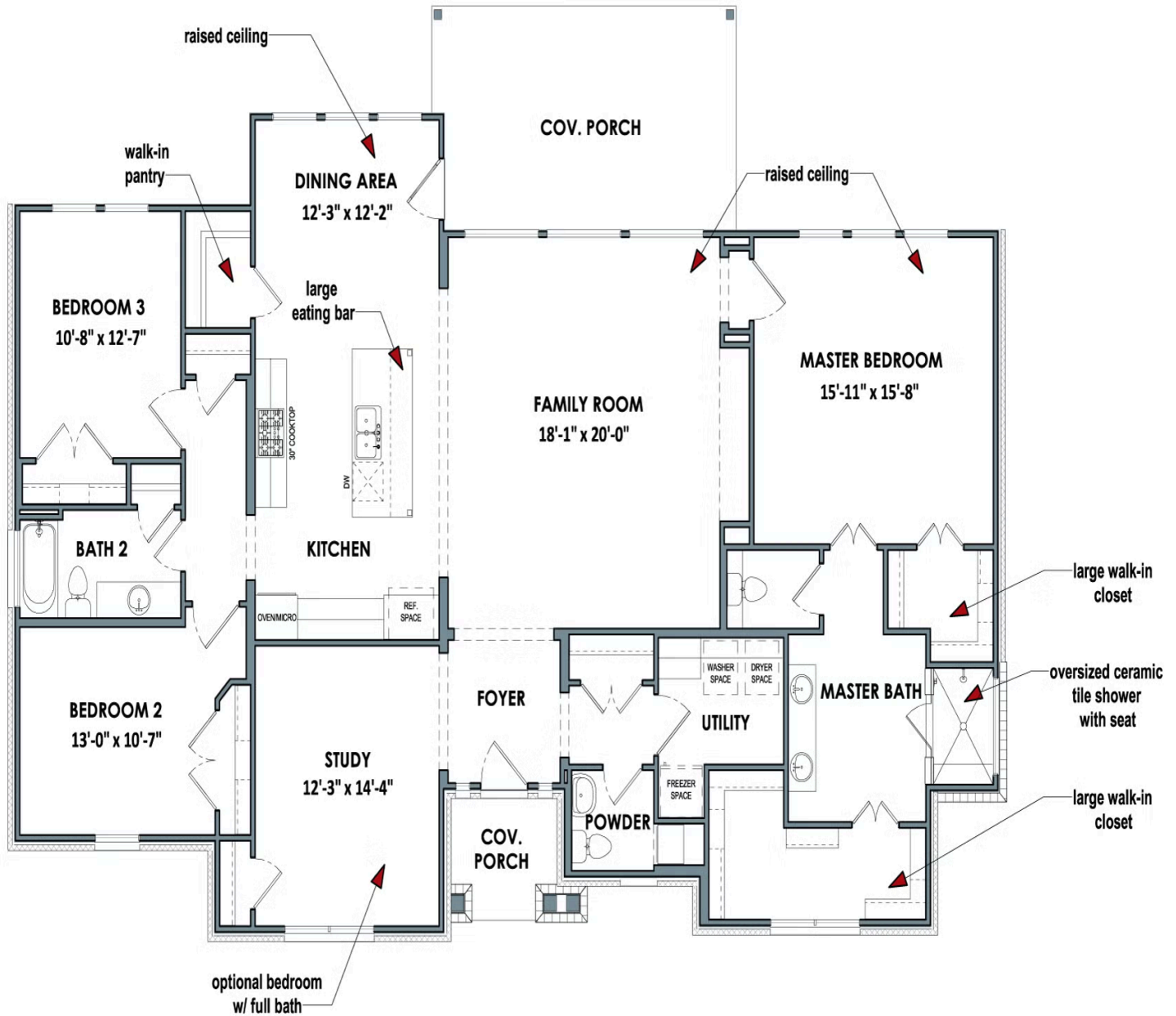

[WWW.TILSONHOMES.COM](http://WWW.TILSONHOMES.COM)

